

IMPORTANT

Please read and understand these instructions before installing your flagpole.

It is important to select a location for your pole where it cannot be struck by automobiles, bicycles, lawnmowers, or any object that can damage it. Avoid any overhead obstructions.

AVOID ANY LOCATION IN THE VICINITY OF POWER LINES.

Always contact your local "DIG SAFE" service before digging or excavating the area.

Do not allow the pole to lie around a job site. Keep the pole straight and dry during storage and erect as soon as possible after delivery.

PARTS LIST

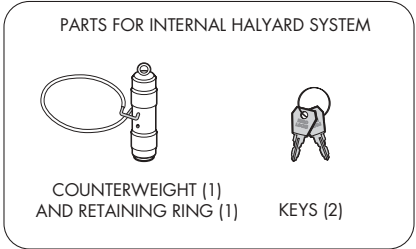
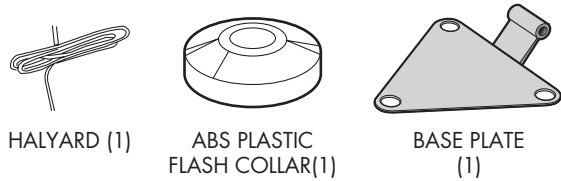
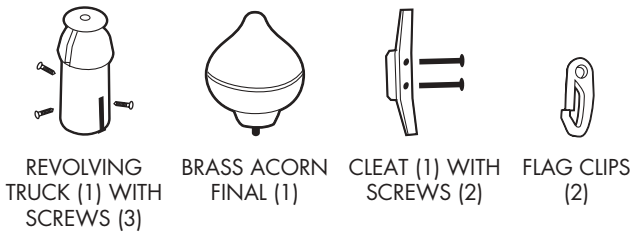
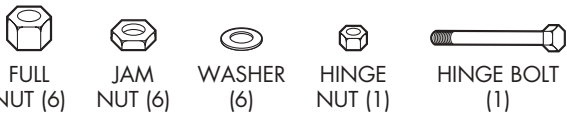

DEALER INFORMATION

INSTALLATION INSTRUCTIONS SIGNATURE™ SERIES

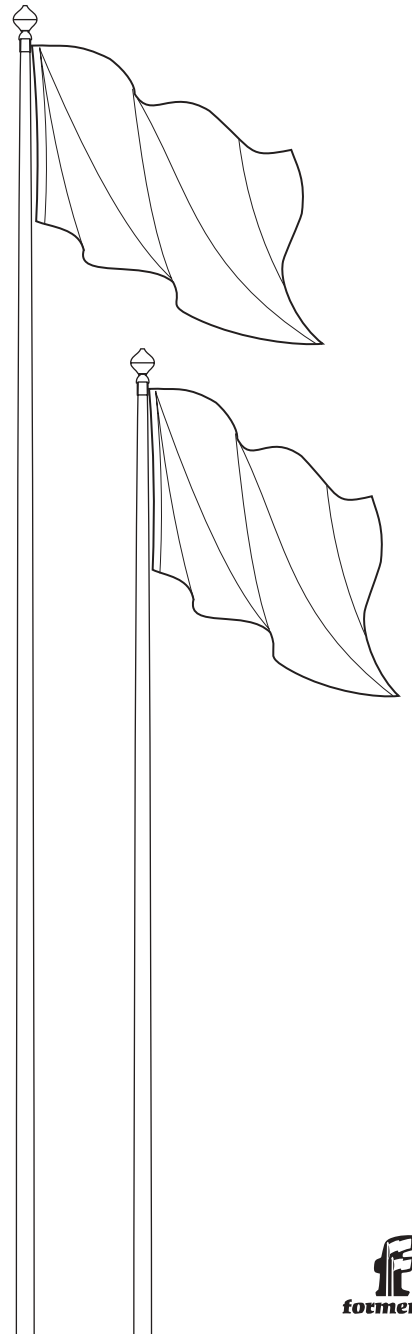

1 FOUNDATION

HOLE DIMENSIONS

FLAGPOLE	20'	25'	30'	35'	40'
Hole diameter	14"	14"	14"	18"	18"
Hole depth	3'	3'	4'	4'	4'



NOTE: hole diameter should be 3-4 times the diameter of the flagpole base.

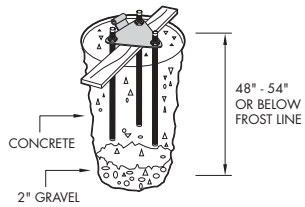

HOLE PREPARATIONS

1. Dig hole according to chart recommendation. If the ground is soft or sandy, increase the diameter of the hole.
2. Fill bottom 2" of hole with crushed stone.

ASSEMBLING GROUND SET

1. Secure base plate (B) to anchor rods (A) by threading down lower jam nuts (C) 3" from end of anchor rods. Add base plate over rods and secure with top jam nuts (C).
2. Once complete, fill hole with concrete.

NOTE: When inserting ground set, make sure hinge bolt is in position to allow for raising and lowering clear of obstruction.

3. Press ground assembly into center of hole. Keep lower base plate above concrete with the assistance of wooden plank. Using a spirit level, check for levelness. Keep exposed rod free of concrete residue.

ALLOW CONCRETE TO CURE

NOTE: Periodically check that assembly remains level during curing of concrete.

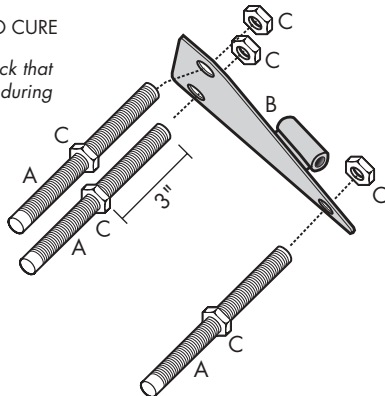

2 FLAGPOLE

1. Leave the plastic wrap on the body of flagpole for protection.
2. Thread halyard through revolving truck and fasten truck to top of flagpole using 3 supplied screws.

NOTE: To prevent halyard from slipping back through truck, tie a temporary knot in halyard

3. Slide flash collar over the flagpole.
4. For internal door assemblies, slip counterweight and retaining ring over pole and tie to end of halyard.
5. Fix (external) cleat to flagpole.

If you purchased a Yardarm or a Yardarm and Gaff, install it at this time. Refer to the instructions for Yardarm, Yardarm and Gaff assembly installation

EXTERNAL HALYARD

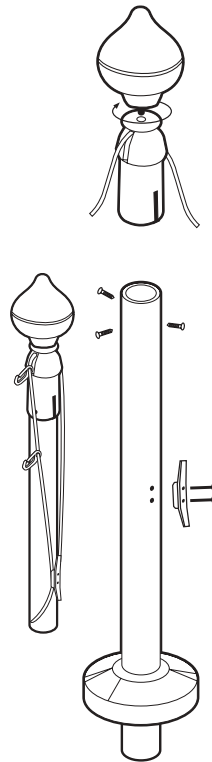

INTERNAL HALYARD

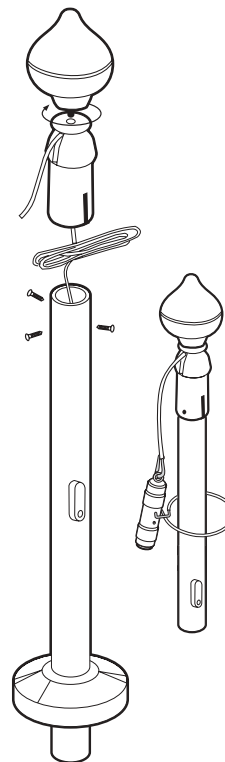

3 RAISING

1. When the cement is firmly set, remove all plastic wrap from flagpole.
2. Thread lower full nuts (F) onto anchor rods, leaving 1 3/4" of exposed rod then place lower washers (G).
3. Join base of flagpole to base plate with hinge bolt and nut (H). Hand tighten.
4. When walking flagpole into upright position, fasten finial. Hand tight until secure.

NOTE: After several weeks, check that top nuts have stayed tight and tighten as required.

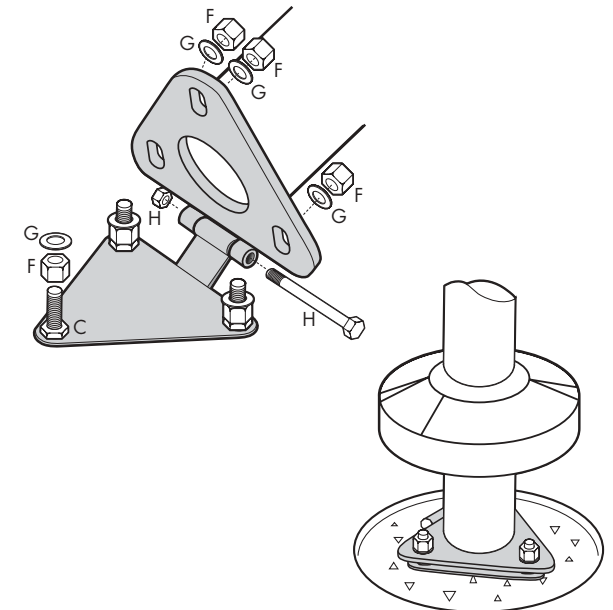

CARING FOR YOUR FIBERGLASS FLAGPOLE

1. Dirt on the pole comes from a dirty halyard. The halyard is machine washable. Replace the halyard often.
2. When the flag is not flying, bring the flag snaps together and wrap them around the cleat to prevent them from hitting the pole.
3. Wipe off dirt marks with soap and water using a sponge. With white poles, stains or old dirt can often be removed with a mild bleach solution. DO NOT use sandpaper or any abrasive material on the surface. The pole can be polished with a non-abrasive cleaning compound recommended for fiberglass surfaces.
4. Proper flag etiquette precludes flying the flag in inclement weather. Furthermore, the flag should not be flown in high winds. It can damage the pole and place unnecessary wear on the flag.